

# Health AI and Health Policy—Charting a Path for Patients and Progress

A Duke-Margolis Health Policy Matters Special Event



Monday, October 28, 2024 • 3:00 – 5:00 pm  
Geneen Auditorium, Fuqua School of Business, Duke University



## HEALTH AI AND HEALTH POLICY — CHARTING A PATH FOR PATIENTS AND PROGRESS ATTENDEE KNOW BEFORE YOU GO

Thank you for registering to attend the Health AI and Health Policy — Charting a Path for Patients and Progress on October 28, 2024 from 3:00 pm - 5:00 pm ET. To help you to prepare, we've put together this quick reference guide so you're ready for a successful event. Please email us at [margolisevents@duke.edu](mailto:margolisevents@duke.edu) with any additional questions.

### GENERAL INFORMATION

**DATE** October 28, 2024

**TIME** Registration Opens: 2:30 pm  
Presentations & Discussion: 3:00 pm – 5:00 pm (Geneen Auditorium)  
[Click here](#) for an up-to-date agenda.

### ATTIRE

Attire for the event is business/business casual. We do recommend you dress in layers as temperatures in meeting spaces can vary.

### LOCATION

Geneen Auditorium  
First Level  
Fuqua School of Business, Duke University  
100 Fuqua Drive  
Durham, NC 27708

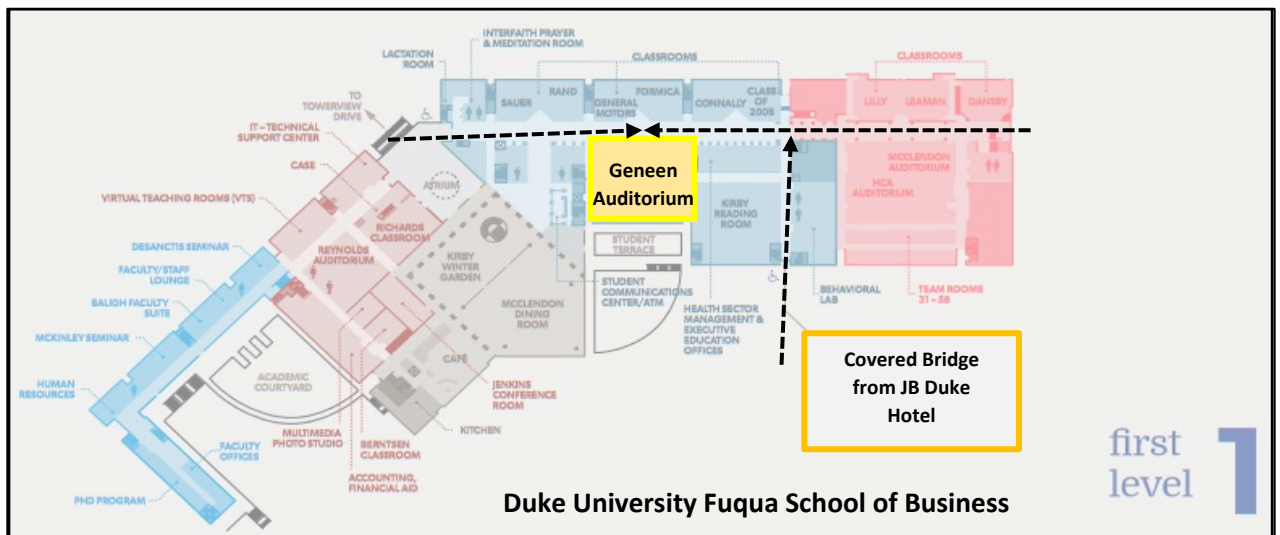

## GETTING THERE

### PARKING

#### Option 1: [Science Drive Visitors Lot](#)

- Enter off of Science Drive near Fuqua School of Business
- Equipped with meters that accept cash, credit, and debit
- Rate: \$2.00/hour

#### Option 2: [Science Drive Parking Garage](#)

- Enter off of Science Drive near JB Duke Hotel
- Equipped with meters that accept cash, credit, and debit
- Rate: \$2.00/hour

#### Overflow Parking: [Bryan Center Lot](#)

- Enter off of Science Drive near by Bryan Center and Chapel
- Equipped with meters that accept cash, credit, and debit
- Rate: \$2.00/hour

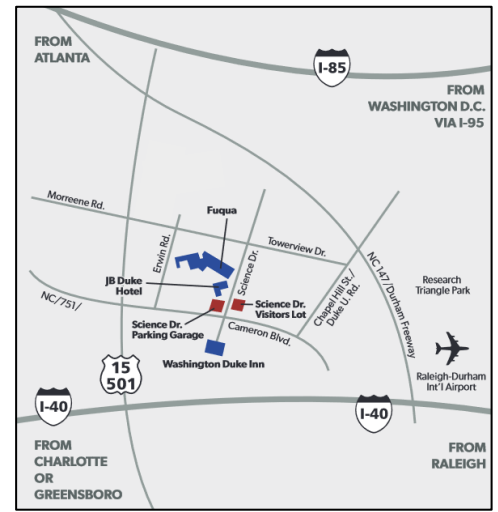

### DIRECTIONS

From RDU Airport

Take I-40 West to Exit 279B (Durham Expressway/NC 147 North). Continue on the Durham Expressway and follow signs to take Exit 16B for US 15-S/US-501 South towards Chapel Hill. Continue on 15/501 South until you reach exit 107 - NC 751/Duke University. After exiting, turn left onto NC 751. At the third traffic light, turn left onto Science Drive. After a short drive down, turn right into the parking Visitor Parking Lot.

From Atlanta/Charlotte (South)

Take I-85 North to Durham, Exit 173. Make a right onto U.S. 15/501 South. Continue on 15/501 south until you reach exit 107 - NC 751/Duke University. After exiting, turn left onto NC 751. At the third traffic light, turn left onto Science Drive. After a short drive down, turn right into the parking Visitor Parking Lot.

From Washington/Philadelphia (North)

From I-95 South, go through Richmond to Petersburg, VA. Follow the signs to I-85 South (Durham). Upon entering the Durham city limits, take exit 174A onto U.S. 15/501 South (Duke University/Chapel Hill). Take exit 107 - NC 751/Duke University. After exiting, turn left onto NC 751. At the third traffic light, turn left onto Science Drive. After a short drive down, turn right into the parking Visitor Parking Lot.

## NAVIGATING FUQUA

This event will be held in the Geneen Auditorium in Fuqua School of Business. The auditorium is located on the first level of the building. Please follow the Health AI and Health Policy — Charting a Path for Patients and Progress directional signage posted at each of the building entrances.